

15" R Machine Addendum for V 4.1

Overview: Some upgrades and changes have been made to your machine since the original manual was printed. We've created this notice to keep you up-to-date on your new equipment! All of the following information will appear in new editions of the user manual going forward.

Parts & Tools Update



**Open-End
7 mm Wrench**

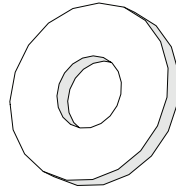

Washer M5

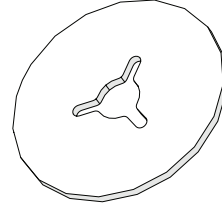

Plastic Washer M4

The open-end 7 mm wrench and two washers are no longer included in the machine kit.

Attaching the Thread Mast Update

The open-end 7 mm wrench is no longer needed. Simply tighten the hex nut by hand.

